

MAGNIFICO FIT

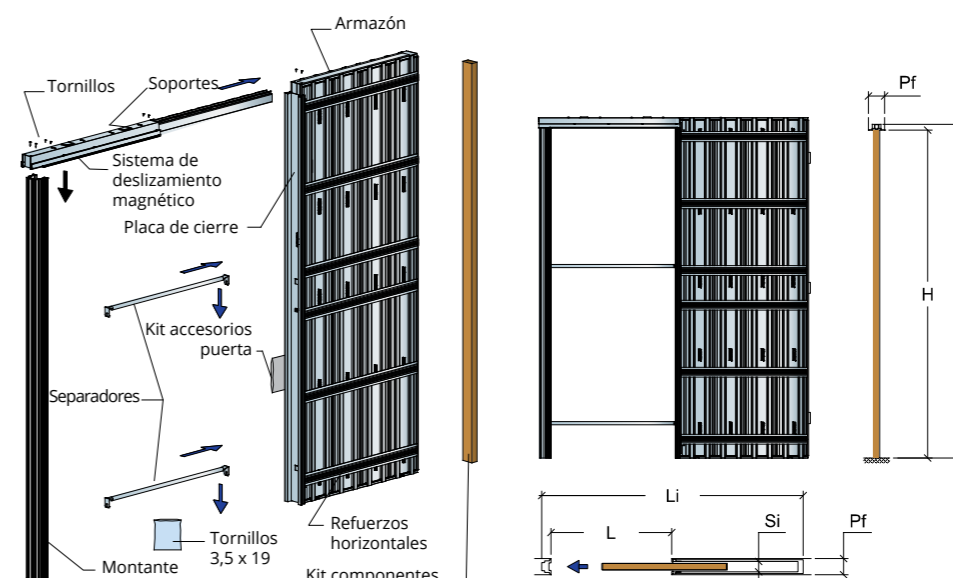
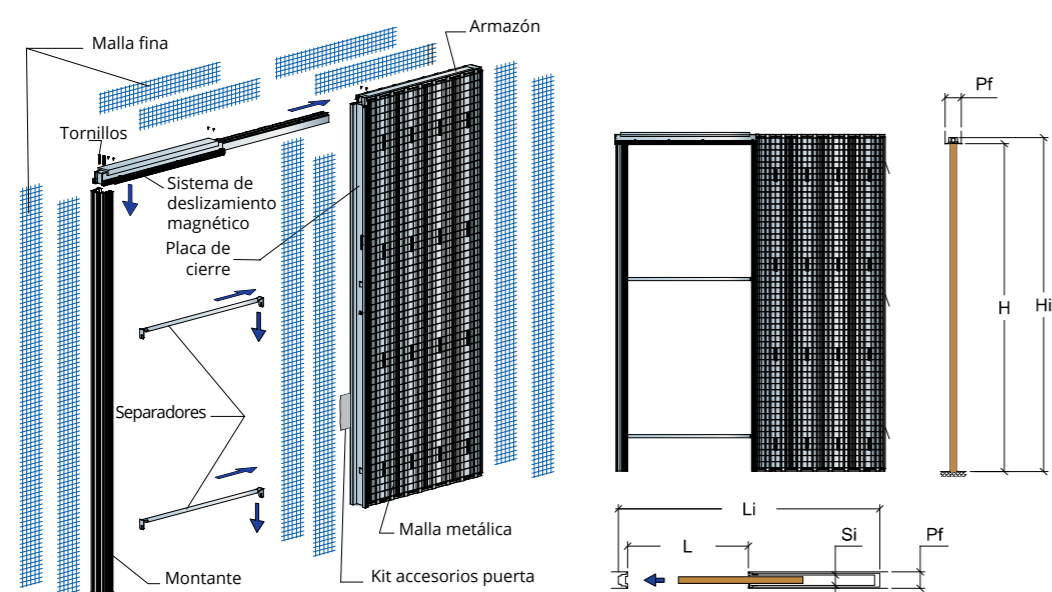

HASTA 40 KG

HASTA 40 KG

| LUZ DE PASO | | MEDIDA TOTAL | | PARED ACABADA/ HUECO INTERIOR | MEDIDAS DE LA HOJA | | GROSOR DE LA PARED DE SOPORTE | GROSOR DE LA HOJA |
|-------------|--------------|--------------|--------------|----------------------------------|--------------------|--------------|----------------------------------|----------------------|
| L | H | Li | Hi | Pf / Si | Lp | Hp | F | P |
| 600 | 1800 2400 | 1320 | 1880 2480 | 105/69 125/89 | 615 | 1795 2395 | 80 100 | 43 43 |
| 700 | | 1520 | | | 715 | | | |
| 800 | | 1720 | | | 815 | | | |
| 900 | | 1920 | | | 915 | | | |
| 1000 | | 2120 | | | 1015 | | | |

| LUZ DE PASO | | MEDIDA TOTAL | | PARED ACABADA/ HUECO INTERIOR | MEDIDAS DE LA HOJA | | GROSOR DE LA PARED DE SOPORTE | GROSOR DE LA HOJA |
|-------------|--------------|--------------|--------------|----------------------------------|--------------------|--------------|----------------------------------|----------------------|
| L | H | Li | Hi | Pf / Si | Lp | Hp | O | P |
| 600 | 1800 2400 | 1320 | 1880 2480 | 100/54 125/69 | 615 | 1795 2395 | 75 100 | 40 43 |
| 700 | | 1520 | | | 715 | | | |
| 800 | | 1720 | | | 815 | | | |
| 900 | | 1920 | | | 915 | | | |
| 1000 | | 2120 | | | 1015 | | | |

Leyenda

L = Ancho luz
H = Altura luz
Li = Ancho total
Hi = Altura total
Pf = Pared acabada
Si = Huevo interior

Capacidad: 40 kg
Apertura y cierre ralentizados de serie
La anchura de paso real se reduce en 10 mm.

Leyenda

L = Ancho luz
H = Altura luz
Li = Ancho total
Hi = Altura total
Pf = Pared acabada
Si = Huevo interior

Capacidad: 40 kg
Apertura y cierre ralentizados de serie
La anchura de paso real se reduce en 10 mm.